

- ① — IKO PermaTEC waterproofing membrane
- ② — IKO PermaFLASH R reinforcement between two coats of PermaTEC
- ③ — IKO PermaGUARD F protection sheet
- ⑧ — IKO Enertherm XPS Insulation board
- ⑩ — IKO Enertherm Ustand Board with factory applied cementitious face
- ⑬ — IKO WCL filter sheet
- ⑮ — 20x40 washed & rounded ballast laid as bed 50mm thick
- ⑥① — Plastisol coated metal flashing, size depends on the insulation thickness
- ⑥② — Aperture cold applied system
- ⑥③ — 0.7mm Plastisol coated metal carrier membrane
- ⑥④ — 0.4mm Alutrix FR VCL
- ⑥⑤ — Rockwool Hardrock Multi-Fix Insulation board Min. 105mm thickness Max 350mm thickness
- ⑥⑥ — 15.9mm (5/8") DensDeck Prime Roof Board, with staggered joints
- ⑥⑦ — 1.6mm galvanized top hats, mechanically fixed, cross braced to suit the site opening
- ⑥⑧ — 1.6mm Zed bracket fixed to upstand kerb
- ⑥⑨ — EJOT DMH 8 Hammer in Anchor Mech Fixed Min. 40mm into dense concrete
- ⑨⑩ — Hotmelt compatible EPDM indicative & by others, bonded onto hotmelt min. 100mm

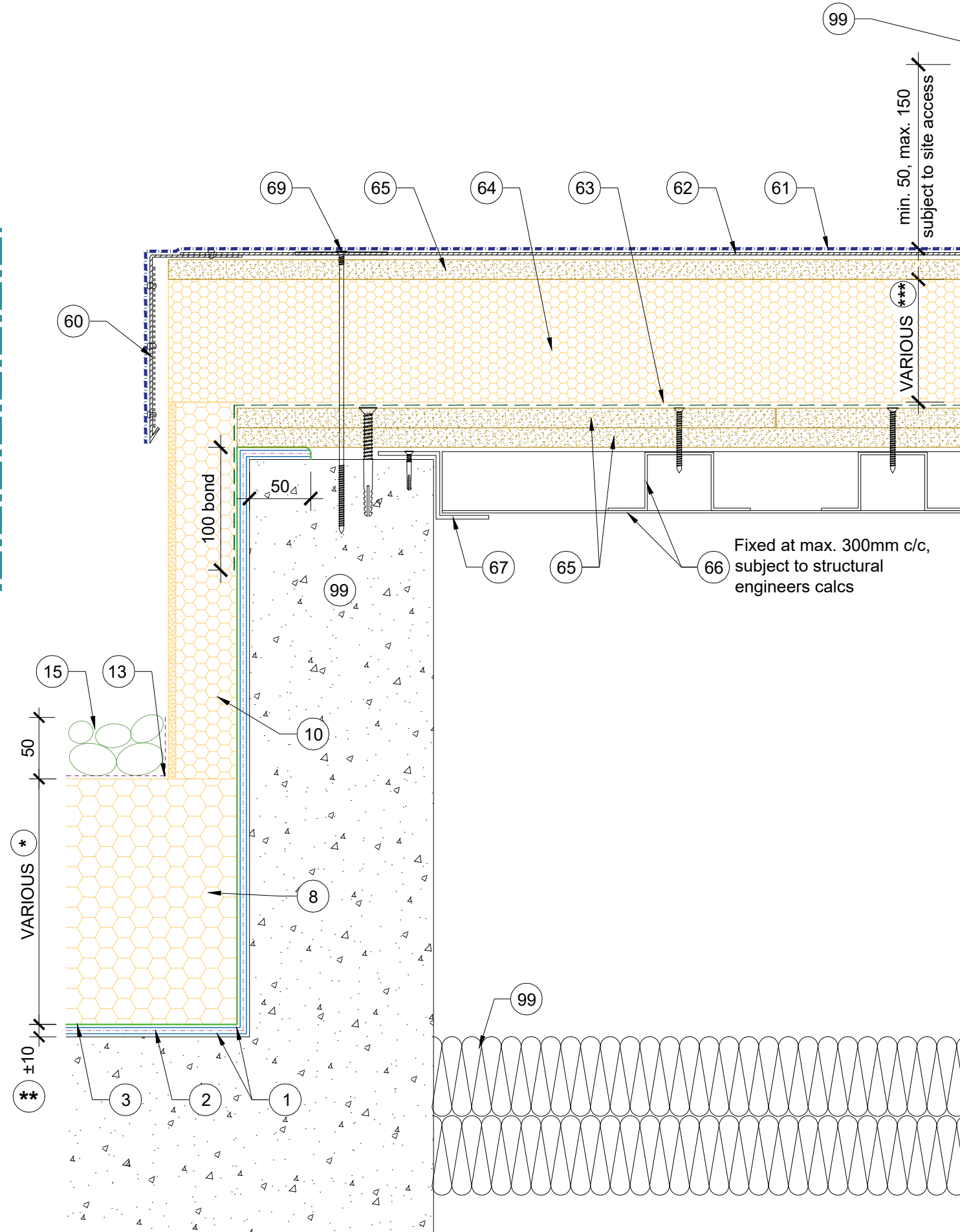

INDICATIVE DUCTWORK

DensDECK Prime roof board double layered over top hat steel supports

THIS DRAWING MUST NOT BE SCALED, WRITTEN DIMENSIONS ONLY
DO NOT SCALE - IF IN DOUBT ASK

NOTES :-
ALL INTERFACES BETWEEN DIS-SIMILAR METALS MUST BE ISOLATED.
ALL MATERIALS ADHERING TO, OR IN CONTACT WITH, THE PERMA-TEC WATERPROOFING MUST BE COMPATIBLE WITH THE PERMA-TEC SYSTEM AND MUST BE NON-PENETRATIVE.

POTENTIAL CDM HAZARDS
THIS DRAWING IDENTIFIES POTENTIAL SIGNIFICANT HAZARDS AND REQUIRED METHODS OF WORKING/SEQUENCE THAT A COMPETENT CONTRACTOR MAY NOT BE ABLE TO IDENTIFY

DEMOLITION	CONSTRUCTION	MAINTENANCE	REFURBISH
	<input checked="" type="checkbox"/> Manual handling <input checked="" type="checkbox"/> Working at height <input checked="" type="checkbox"/> Hot Works <input checked="" type="checkbox"/> Trip Hazard		
			Hotmelt max 50mm on parapet

Waterproofing to be installed maximum 50mm on top of parapet (if required). Any deviation from this must have Director approval.



P01	FIRST ISSUE	-	-
Rev	Description	By	Date

PURPOSE OF ISSUE
FOR INFORMATION

BriggsAmasco
roofing your world

Briggs Amasco Ltd,
Premier House
Station Road
Harold Wood, Essex
RM3 0BS
Telephone: (020) 8536 6630
E-mail: purobel@briggsamasco.com

Client
ApertureFR

Typical Riser Lid
Build Up

Contract

Scale	NTS	© A3
Drawn By	PW	Checked By MK
Date	07/25	Date 07/25

Title
Typical ApertureFR Cold Duct Insulated Riser Lid Waterproofing Detail

Drawing No.	BAM- APFR-DRW-0001	Rev	P01
-------------	--------------------	-----	-----